



H10 & H19 Implement Hitch Mount

Operator's Manual

Assembly, Attaching, Removing, Operation and Maintenance

H10 compatible with Models C, D, T

H19 compatible with Model H



Please Read and Save These Instructions

For Safety, Read All Assembly and Operation Instructions
Prior to Operating Attachment

Beginning S/N: 10-4651

Effective Date: 03.29.10

P/N: 6618-1



Foreword

Thank you. . .for purchasing a Walker Implement Hitch Mount. Every effort has been made to provide you with the most reliable machine on the market, and we are sure you will be among our many satisfied customers. If for any reason this product does not perform to your expectations, please contact your local dealer. Every customer is important to us. Your satisfaction is our goal.

Please. . .read this manual thoroughly! Before you operate your machine, please read this entire manual. Some of the information is crucial for proper operation - it will help protect your investment and ensure that the machine performs to your satisfaction. Some of the information is important to your safety, and must be read and understood to help prevent possible injury to the operator or others. If anything in this manual is confusing or hard to understand, please contact your local authorized dealer or call our service department, at (970) 221-5614, for clarification before operating or servicing this machine.

All shields and guards must be in place for the proper and safe operation of this machine. Where they are shown removed in this manual, it is for illustration purposes only. **Do not operate this machine unless all shields and guards are in place.**

Walker Mfg. Co. is continually striving to improve the design and performance of its products. We reserve the right to make changes in specifications and design without thereby incurring any obligation relative to previously manufactured products.

Sincerely,

WALKER MANUFACTURING COMPANY

Bob Walker, President

Table of Contents:

Safety Instructions _____	1
Decals _____	5
Assembly _____	6
Attaching Implement Hitch _____	10
Operation _____	13
Removing Implement Hitch _____	15
Maintenance _____	16
Parts List/Diagram _____	19
Warranty _____	24

HIGHLIGHTED INFORMATION

Walker Manufacturing recommends that any service requiring special training or tools be performed by an authorized Walker Mower Dealer. There are several general practices to be aware of in the area of safety. Most accidents associated with the operation or maintenance of a Walker product are caused by disregarding basic safety precautions or specific warnings. Such accidents, in most cases, can be prevented by being aware of the dangers present. Information of special importance has been highlighted in bold type.

Safety Instructions

BEFORE OPERATING

1. **Read and understand the contents of this Operator's Manual before operating the machine.** Become thoroughly familiar with all controls and how to stop the machine and disengage the controls quickly. Replacement Operator's Manuals are available on www.walkermowers.com or by sending the model and serial number to:
Walker Manufacturing Company
5925 E. Harmony Road
Fort Collins, CO. 80528
2. **Never allow children to operate or give rides on the machine.** Do not allow adults to operate without proper instruction.
3. Do not allow anyone other than the operator on the machine.
4. Keep everyone, especially children and pets, a safe distance away from the area of operation. **Do not operate with bystanders in the area.**
5. Do not operate the machine wearing sneakers, tennis shoes, or similar lightweight footwear. **Wear substantial protective footwear that will improve footing on slippery surfaces.**
6. Do not wear loose fitting clothing that could get caught in moving parts. **Always wear adequate protective clothing** including long pants. Wearing safety glasses, safety shoes, and a helmet is advisable and required by some local ordinances and insurance regulations.
7. Prolonged exposure to loud noise can cause impairment or loss of hearing. **Operator hearing protection is recommended.** Wear a suitable hearing protective device such as earmuffs or earplugs.
8. **Keep all protective shields and safety devices in place.** If a protective shield, safety device, or decal is damaged, unusable, or missing, repair or replace it before operating the machine.
9. **Be sure any interlock switches are functioning correctly** so the engine cannot be started unless the Forward Speed Control (FSC) lever is in the **NEUTRAL** position and the PTO clutch is in the **DISENGAGED** position. Also, the engine should stop if the operator lifts off the seat with the PTO clutch in the **ENGAGED** position.

10. **Never attempt to make any adjustments while the engine is running**, except where specifically instructed to do so.
11. **Handle gasoline or diesel fuel with care.** Gasoline is highly flammable and its vapors are explosive:
 - a. Use an approved fuel container.
 - b. Never add fuel to a running engine or hot engine (allow hot engine to cool several minutes).
 - c. Keep matches, cigarettes, cigars, pipes, open flames, or sparks away from the fuel tank and fuel container.
 - d. Always fill the fuel tank outdoors using care. Fill to about one inch from the top of the tank. Use a funnel or spout to prevent spilling.
 - e. Replace the machine fuel cap and container cap securely and clean up any spilled fuel before starting the engine.

OPERATING

NOTE: Refer to your model's Operator's Manual for safety instructions for operating the tractor.

1. Operate the machine only in daylight or in good artificial light with good visibility of areas being cleaned.
2. Sit on the seat when starting the engine and operating the machine. Keep feet on footrests at all times when the tractor is moving and/or the implement is operating.
3. An inexperienced operator should **learn to steer (maneuver) the tractor with a slow engine speed before attempting any operating.** Be aware that, with the front mounted implement configuration, the back of the machine swings to the outside during turns.
4. Remember, for an emergency stop, the forward motion of the tractor can always be stopped by pulling the Forward Speed Control (FSC) into the **NEUTRAL-PARK** position.
5. Disengage the PTO clutch and put the FSC in the **NEUTRAL-PARK** position before starting the engine (an ignition interlock switch normally prevents starting of the tractor if these controls are in the **OPERATING** position).
6. **Do not run the engine in a confined area without adequate ventilation.** Exhaust fumes are hazardous and can be deadly.
7. **Do not carry passengers** - maximum seating capacity is one (1) person.

8. **Avoid sudden starts or stops.** Before backing the machine up, look to the rear to be sure no one is behind the machine. Watch carefully for traffic when crossing or working near roadways.
9. Disengage the PTO clutch when transporting the machine.
10. Do not operate across the face of slopes. Use extreme caution when changing direction on slopes. Do not attempt to clear steep slopes.
11. Before adjusting height or servicing, disengage the PTO clutch, stop the engine, and remove the ignition key. Wait for all movement to stop before getting off the seat.

<p>NOTE: The PTO brake should normally stop drive line rotation within 5 seconds of disengaging the PTO clutch.</p>
--

12. If the implement strikes a solid object or the machine begins to vibrate abnormally, immediately disengage the PTO clutch, stop the machine, and remove the ignition key. Wait for all moving parts to stop. Disconnect the fuel solenoid wire [diesel engines] or the spark plug wire(s) [gasoline engines] to prevent accidental starting. Thoroughly inspect the implement and repair any damage before restarting the engine and operating the machine. Make sure implement components are in good condition and all bolts are tight.
13. **Do not touch the engine or muffler while the engine is running** or immediately after stopping the engine. These areas may be hot enough to cause serious burns.
14. When leaving the machine unattended, disengage the PTO clutch, stop the engine, and remove the ignition key.

MAINTENANCE

<p>NOTE: Refer to the appropriate Operator's Manual for proper tractor maintenance procedures.</p>

1. **To prevent accidental starting of the engine** when servicing or adjusting the machine, remove the key from the ignition switch and disconnect the fuel solenoid wire [diesel engines] or the spark plug wire(s) [gasoline engines]
2. **To reduce fire hazards**, keep the engine free of grass, leaves, excessive grease, and dirt.
3. Keep all nuts, bolts, and screws tight **to ensure the machine is in a safe, working condition.**

4. **Perform only maintenance instructions described in this manual.** Unauthorized maintenance operations or machine modifications may result in unsafe operating conditions.
5. If the engine must be running to perform a maintenance adjustment, **keep hands, feet and clothing away from moving parts. Do not wear jewelry or loose clothing.**
6. **Always use proper engine service manuals when working on the engine.** Unauthorized maintenance operations or modifications to the engine may result in unsafe operating conditions.
7. Altering the machine in any manner which adversely affects its operation, performance, durability or use **will VOID the warranty** and may cause hazardous conditions.
8. Never attempt to disconnect any safety devices or defeat the purpose of these safety devices.
9. Do not change the engine governor settings or overspeed the engine. The governor has been factory-set for maximum-safe engine operating speed.
10. **Use genuine factory replacement parts.** Substitute parts may result in product malfunction and possible injury to the operator and/or others.

<p>IMPORTANT: Keep all applicable manuals immediately accessible to anyone who may operate or service this machine.</p>
--

Decals

SAFETY, CONTROL, AND INSTRUCTION DECALS

Safety, Control and Inspection Decals are installed on the machine. If any are missing, illegible, or damaged, a replacement should be ordered and installed before putting the machine into operation. The Decal Part Number is listed below along with the Decal Location.

Safety Decal: Rotating Driveline

Location: PTO Shield

Part Number: 7822



Adjustment Decal: Locking Mechanism - H19 ONLY

Location: PTO Shield

Part Number: 6623

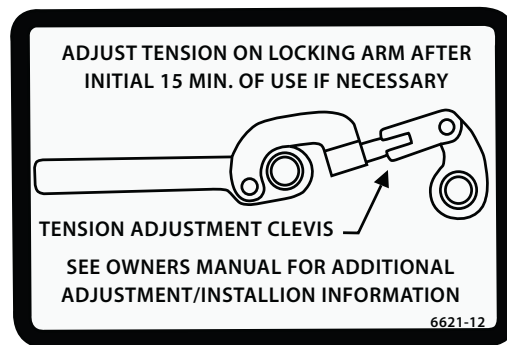

Operation Decal: Toggle Switch

Location: Forward Speed Control (FSC) Lever

Part Number: 6632

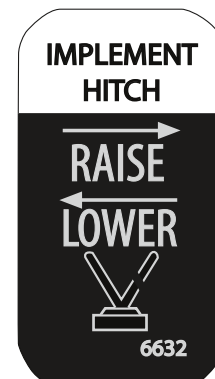

Adjustment Decal: 3/4" Bolt - H10 ONLY

Location: Frame of H10 Implement Hitch

Part Number: 6618



Assembly

Implement Hitch

An implement hitch is required to mount implements to the tractor, and can be attached to the tractor in place of the mower deck in less than a minute. Each implement slides onto the male hitch and easily locks in place. The implement hitch also includes operator foot rests and an electric power lift. The lift control switch is mounted on the Forward Speed Control (FSC) lever for convenient operator use, and controls a linear actuator on the implement hitch.

Walker implement hitches are shipped partially assembled. After uncrating the implement hitch, initial setup is required.

H10 Implement Hitch Wiring: Models C, D, and T

1. Attach the toggle switch mounting bracket to the FSC lever using two (2) 10-24 x 1/2" bolts and Keps nuts (figure 1.1).

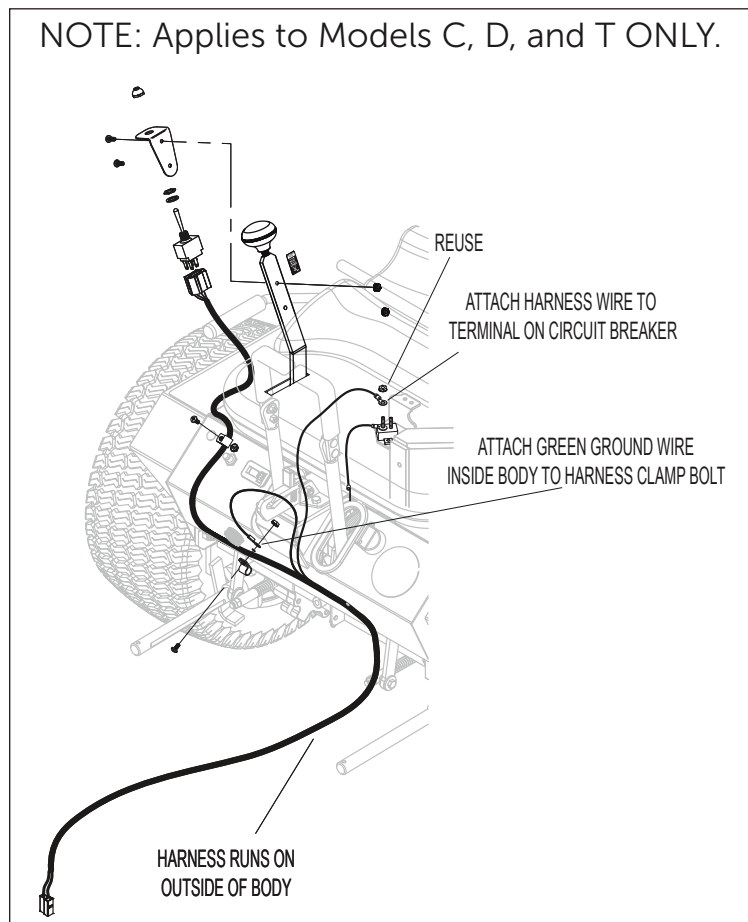

Figure 1.1

2. Attach the toggle switch to the mounting bracket, placing the switch terminals toward the front of the mower.
3. If a hole is not present in the location shown in figure 1.2, drill a 3/16 in. hole in the right front body to attach the cable clamp. Measure 1-3/4 in. from the edge of the body, and 7/8 in. down from the top of the body as shown in figure 1.2.
4. Connect the wiring harness to the switch and route the harness. Install the wiring harness to the tractor body using the two wiring clamps, two 10-24 x 3/8" bolts and Keps nuts (figure 1.1).
5. Attach the ground wire ring terminal to the inside of the body using the lower cable clamp mounting bolt (figure 1.1).

NOTE: Grind the paint away under the ground wire ring terminal to ensure a good ground connection.

6. Connect the harness red wire to the load side of the circuit breaker mounted on the bracket behind the battery (figure 1.3)

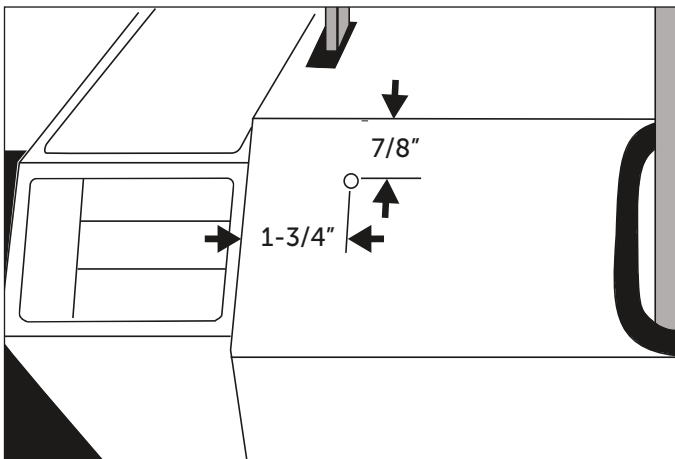

Figure 1.2

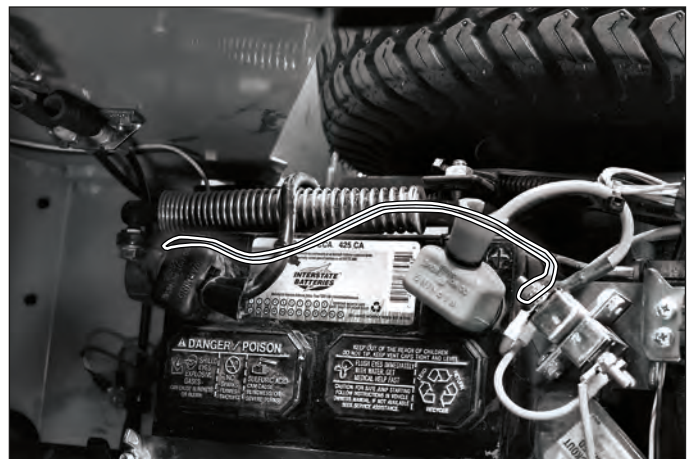

Figure 1.3

H19 Implement Hitch Wiring: Model H

1. Attach the toggle switch mounting bracket to the FSC lever using two (2) 10-24 x 1/2" bolts and Keps nuts (figure 1.4).
2. Attach the toggle switch to the mounting bracket, placing the switch terminals toward the back of the mower (figure 1.4).
3. Connect the wiring harness to the switch and route the harness through the FSC slot ahead of the FSC lever, and then across the front chassis cross member below the front body hinge.
4. Secure the harness using a cable clamp as shown in figure 1.4. Attach the ground wire ring terminal using the same bolt as the cable clamp.

NOTE: Grind the paint away under the ground wire ring terminal to ensure a good ground connection.

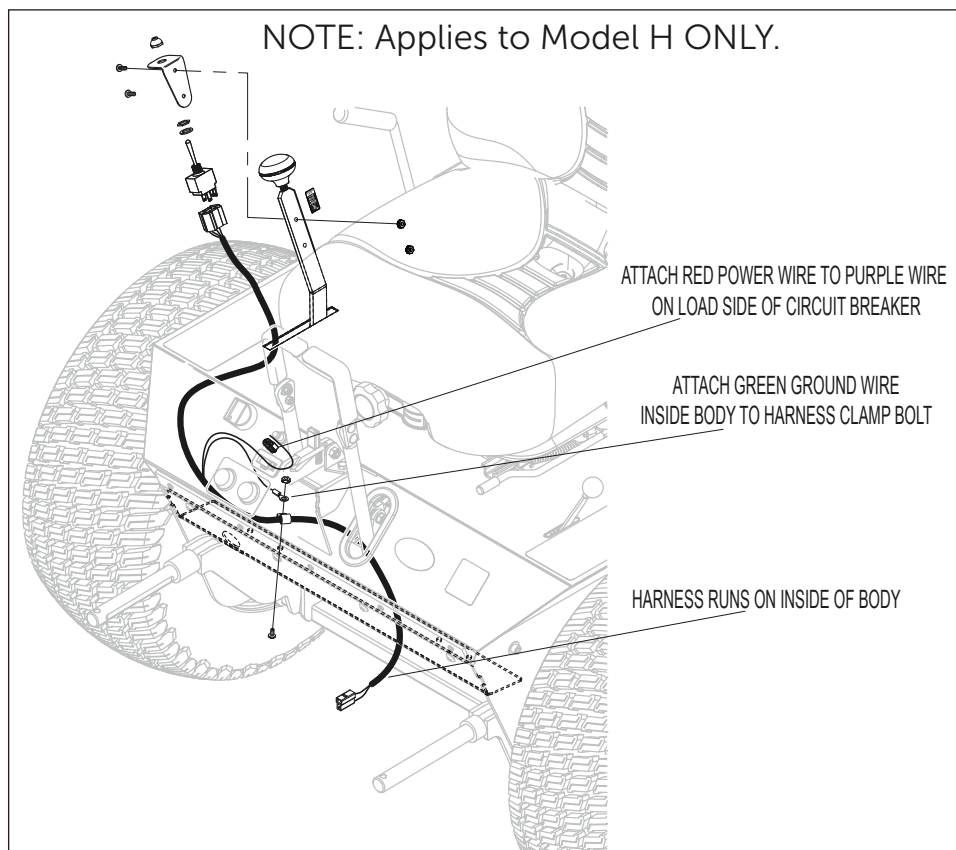
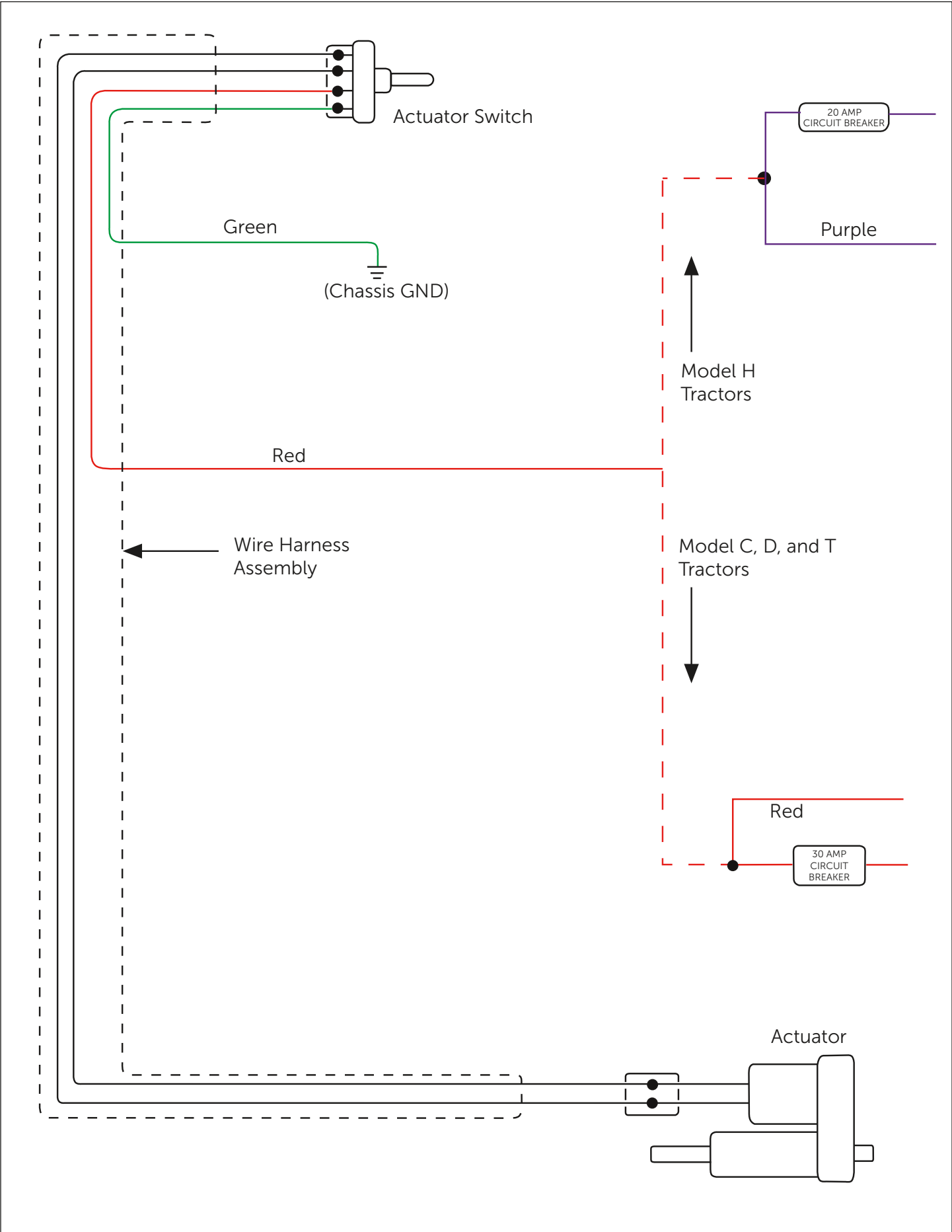

Figure 1.4

5. Using the supplied splice tap, connect the red wire on the harness to the purple wire running between the ignition switch to the 20 amp circuit breaker.

Implement Hitch Wiring Diagram



Attaching Implement Hitch

Attaching H10 Implement Hitch to Models C, D, or T

1. Remove the mower deck from the tractor, if necessary. Refer to the appropriate Tractor Operator's Manual.
2. Lightly grease both support arms on the tractor. Refer to figure 2.1 for location of the support arms.
3. Engage the hitch mounting tube sockets on the support arms. Lift the hitch so the support arms are level, and slide the implement hitch completely onto the support arms.
4. Install a hitch pin through the hole on the end of each support arm to lock the hitch in place (figure 2.1).

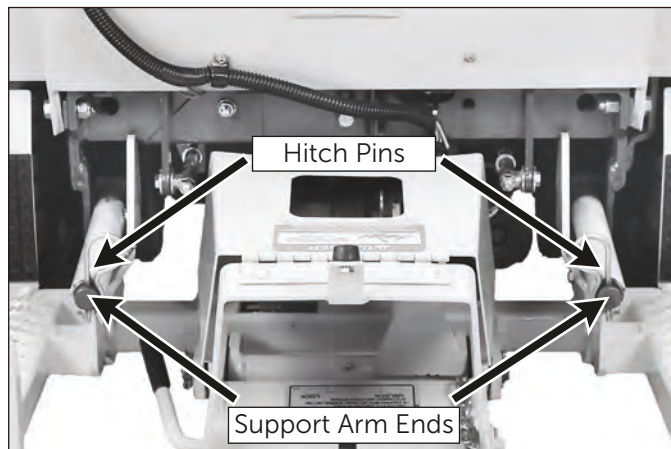

Figure 2.1

IMPORTANT: If the tractor body needs to be raised, the PTO shield must be in the **closed or down position** and the implement must be in the **lowered position**. The only time the PTO shield should be open or raised is when connecting or disconnecting the driveline for the rotary broom, snowblower, or debris blower.

5. Loosen the 3/4-10 jam nut on the back end of the implement hitch. Adjust the 3/4-10 x 2" hex bolt until it contacts the cross-member of the tractor frame. Securely tighten the 3/4-10 jam nut to prevent the bolt from moving.

IMPORTANT: This adjustment will need to be made only once if the same tractor and hitch are used together. If the hitch will be used on more than one tractor, this adjustment will be required every time the hitch is mounted on a different tractor.

6. After the hitch is installed, complete the wiring by connecting the wiring harness to the actuator motor of the implement hitch.
7. Raise and lower the hitch a few times to check the operation and make sure it moves smoothly. If not, make sure the wiring harness ends are connected properly and securely. Refer to the **Implement Hitch Wiring Diagram** illustration.
 - Move the implement lift switch backward to raise the implement hitch to the **UP** position.
 - Move the implement lift switch forward to lower the implement hitch to the **DOWN** position.

Attaching H19 Implement Hitch to Model H

1. Remove the mower deck from the tractor, if necessary. Refer to the appropriate Tractor Operator's Manual.
2. Lightly grease both support arms on the tractor. Refer to figure 2.2 for location of the support arms.
3. Engage the hitch mounting tube sockets on the support arms. Slide the implement hitch completely onto the support arms.
4. Install a linch pin through the hole on the end of each support arm to lock the hitch in place (figure 2.2).
5. Using two (2) 3/8-16 ESNA nuts, install the chassis support straps as shown in figure 2.2.
6. After the hitch is installed, complete the wiring by connecting the wiring harness to the actuator motor of the implement hitch.
7. Raise and lower the hitch a few times to check the operation and make sure it moves smoothly. If not, make sure the wiring harness ends are connected properly and securely. Refer to the **Implement Hitch Wiring Diagram** illustration.
 - Move the implement lift switch backward to raise the implement hitch to the **UP** position.
 - Move the implement lift switch forward to lower the implement hitch to the **DOWN** position.

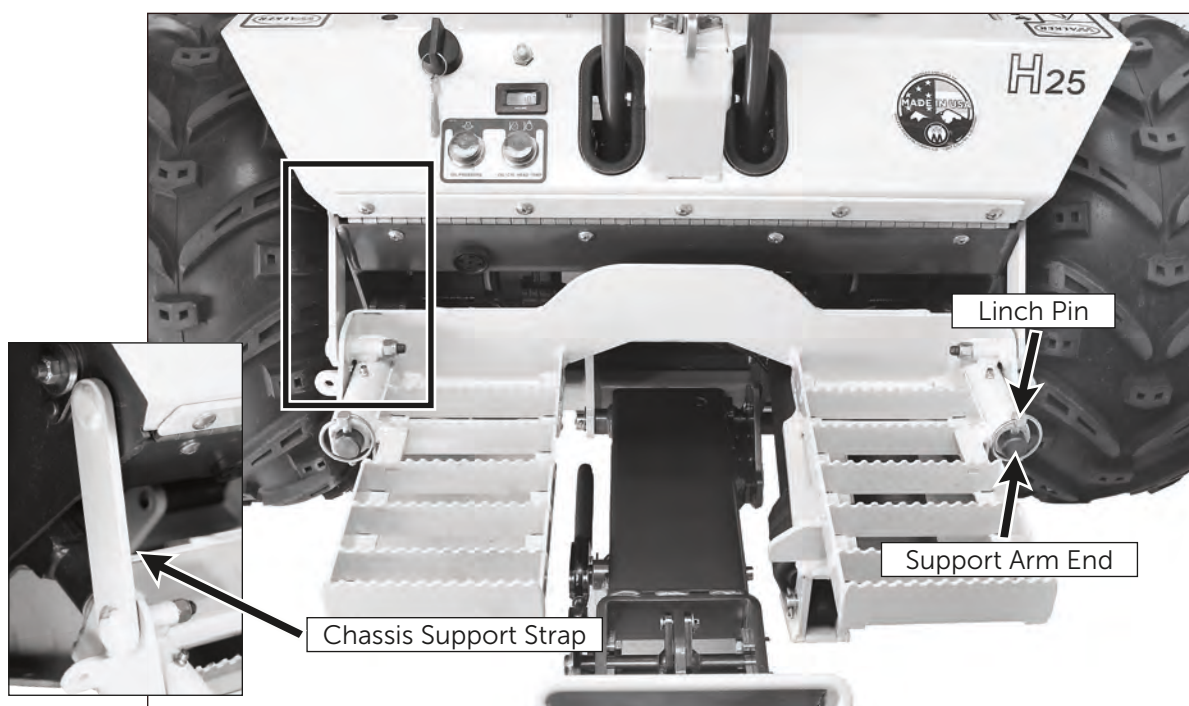

Figure 2.2

Operation

Implements are raised or lowered using the toggle switch located on the FSC lever as shown in figure 3.1.

- Move the switch forward to lower the implement.
- Move the switch backward to raise the implement.

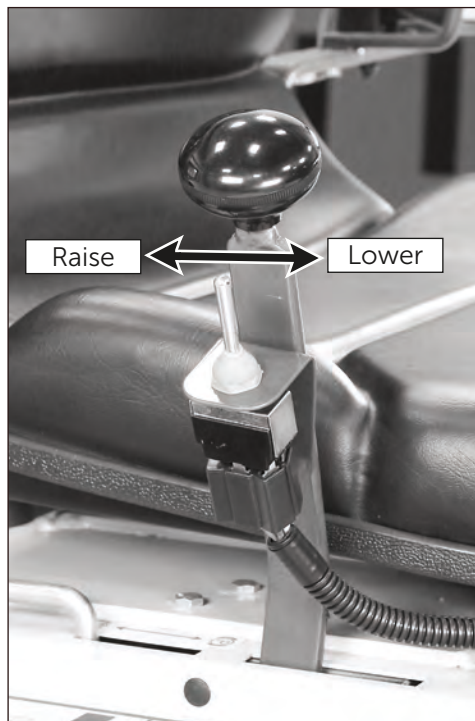

Figure 3.1

Warning ⚠

If an implement is installed on the hitch, it must be locked in place before beginning any operation

All implements must be locked in place on the implement hitch **before beginning any operation**.

H10: Locking/Removing Implements

- **Locking:** Rotate the hitch lock lever **fully forward** to the **LOCKED** position, and secure the hitch latch with the linch pin.
- **Removing:** Remove the linch pin from the latch and move the hitch lock lever backward to the **UNLOCKED** position.

H19: Locking/Removing Implements

- **Locking:** Rotate the hitch lock lever **fully backward** to the **LOCKED** position
- **Removing:** Move the hitch lock lever forward to the **UNLOCKED** position.

H19: Float Function Adjustment

- **Non-Floating:** Insert the clevis pin (figure 3.2) through the rear actuator mount and secure with the bowtie cotter pin. Install the clevis pin to allow for downward pressure on the implement hitch.
- **Floating:** Remove the bowtie cotter pin, and remove the clevis pin from the rear actuator mount (figure 3.3). Removing the clevis pin will allow for a free floating hitch.

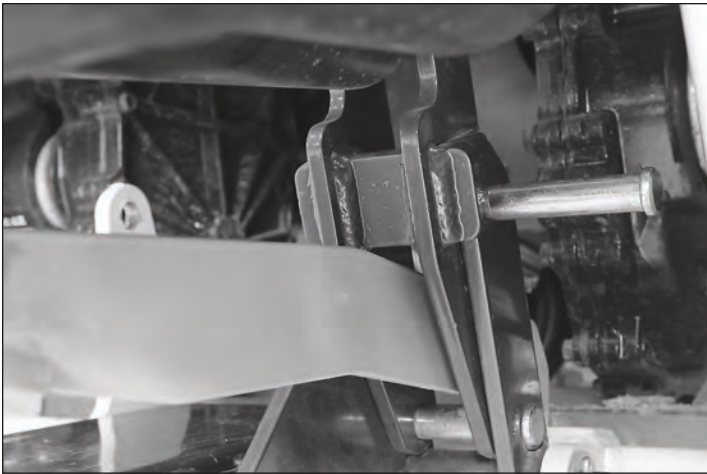

Figure 3.2

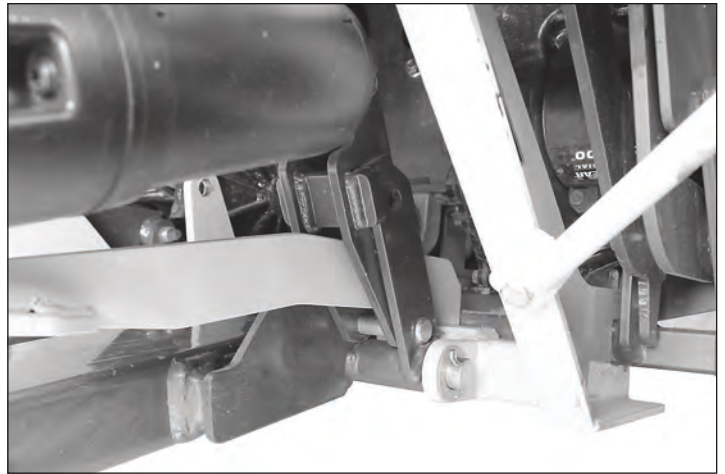

Figure 3.3

Removing Implement Hitch

1. Park the tractor on a level surface and lower the implement hitch.

Warning

DO NOT attempt to remove the implement hitch with the tractor engine running. Stop the engine and remove the ignition key. Wait for all movement to stop before getting off the seat.

To prevent accidental engine starting, disconnect the fuel solenoid wire [diesel engines] or the spark plug wire(s) [gasoline engines].

2. Unplug the linear actuator from the wiring harness on the tractor.
3. On the H19 ONLY, remove the chassis support straps.
4. Remove the hitch pin or linch pin from each support arm and slide the implement hitch off the support arms.

End of Season Storage

1. Clean and inspect the implement hitch thoroughly, noting any replacement parts that will be needed before the next season.
2. Repaint all parts from which paint has worn.

NOTE: Rustproofing or painting every year will prolong the life of the hitch components and moving parts.

3. When the implement hitch is dry, lubricate all moving parts. Apply lubricant liberally to all exposed surfaces to protect against rust.
4. Store the hitch in a dry place.

Maintenance

H19 Hitch Lock Tension Adjustment

After installing an implement onto the hitch, the hitch lock clevis will need to be adjusted according to the following procedure:

1. Adjust the H19 hitch lock clevis to properly secure the implement. To adjust the tension on the tongue latch, remove the bowtie clip and the clevis pin as shown in figure 3.1, and twist the male clevis clockwise to tighten, or counter-clockwise to loosen, as needed.
2. The hitch lock lever should travel approximately 2" at grip end after implement hitch adapter is fully seated on implement hitch tongue as shown in figure 3.2.
3. **Repeat adjustment procedure after first 15 minutes of operation** after installing implement.

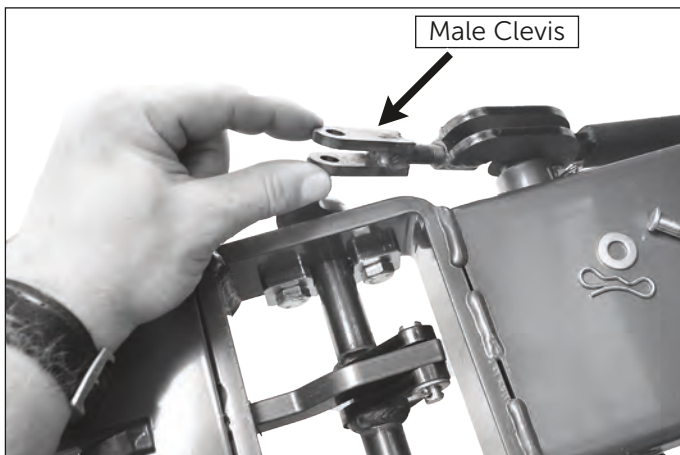

Figure 3.1

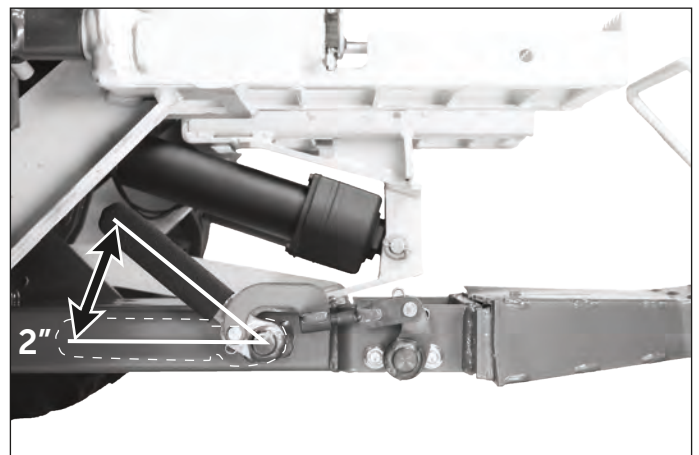

Figure 3.2

Lubrication

Proper lubrication is an important maintenance procedure. It reduces wear and makes the machine quieter and easier to operate.

Warning

DO NOT attempt to lubricate the machine with the tractor engine running. Disengage the PTO clutch, shut off the machine, and remove the ignition key.

NOTE: Tractor Lubrication Points are not shown here. For Tractor Lubrication Points, refer to the appropriate Tractor **OPERATOR'S MANUAL** or **ILLUSTRATED PARTS MANUAL**.

H10 Lubrication Points

Location	Lubrication Type	No. Places
PTO Shield Hinge	Oil	1
Hitch Lift Crank	Grease	1
Mounting Tube Sockets	Grease	2
Hitch Locking Arm	Oil	1
Pivot Shaft	Oil	1

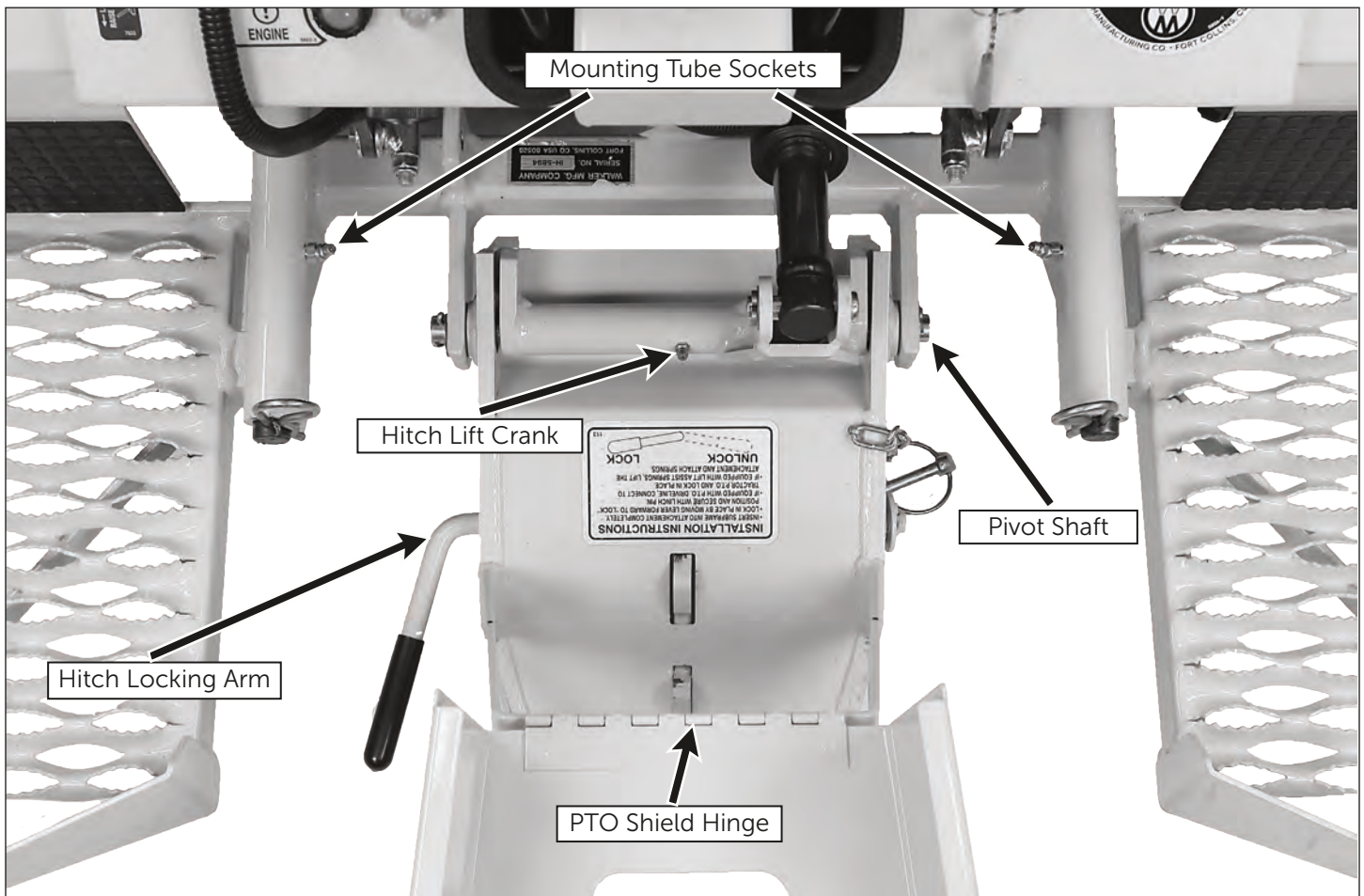

H19 Lubrication Points

Location	Lubrication Type	No. Places
Mounting Tube Sockets	Grease	2
Hitch Locking Arm	Oil	2
Pivot Shaft	Oil	1

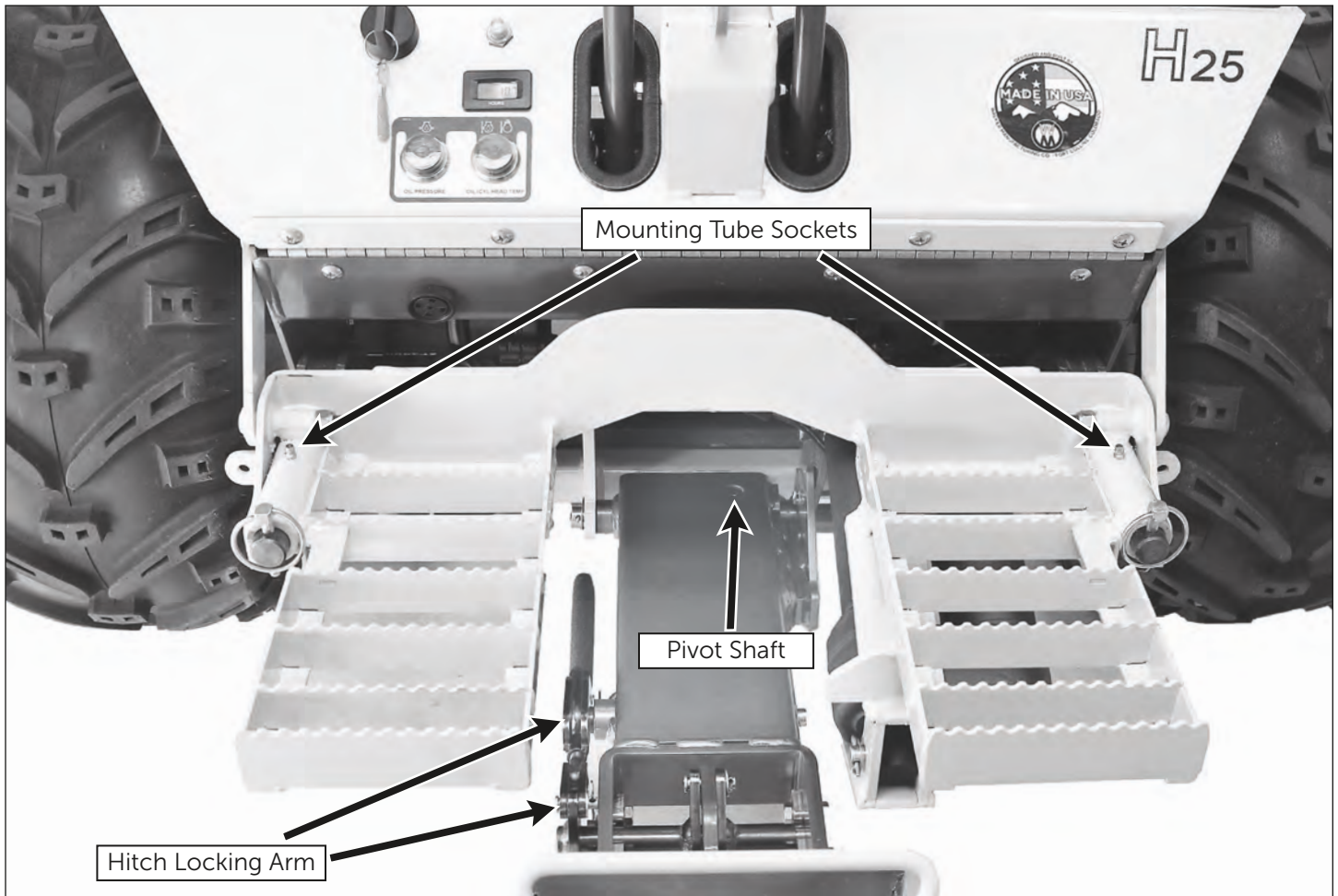

PTO shield has been removed for illustration purposes ONLY

IMPLEMENT HITCH ASSEMBLY (H10)

ITEM NO.	PART NO.	DESCRIPTION	NO. REQ'D	ITEM NO.	PART NO.	DESCRIPTION	NO. REQ'D
Electrical Components				20	5830-3	Grease Fitting (45 Degree)	2
1	6623-1	Switch Boot	1	21	5830	Grease Fitting	1
2	6628	Switch Mount Bracket	1	22	I393	Decal, Attaching Hitch	1
3	6632	Decal, Implement Hitch / Lexan	1	23	F014	3/8-16 ESNA	1
4	6623	Toggle Switch	1	24	I002	Quick Hitch Latch	1
5	6622	Wiring Harness	1	25	F040	3/8-16 x 1-1/2 Hex Bolt	1
6	5832	Cable Clamp (1/2)	2	26	F069	3/32 x 1/2 Cotter Pin	1
Implement Hitch				27	I009	Attaching Lever	1
7	6627	PTO Shield (Includes Item # 32)	1	28	4850	Handle Grip	1
8	I392	Safety Chain Assembly	1	29	I005	1/4 x 1-11/16 Pin	1
	I015	Chain	1	30	NS*	Spring Plate	1
	2775	5/16 x 1-1/4 Linch Pin	1	31	I008	Spring (1/4 x 1)	1
	F068	1/8 x 1 Cotter Pin	1	32	7822	Decal, PTO Shield	1
9	5588	Rubber Bumper (.75 x .50)	1	Fasteners			
10	I001	Quick Hitch	1		F002	10-24 Keps Nut	5
	6625-1	Hitch Assembly, Male	1		F005	1/4-20 ESNA Nut	2
11		F112 5/8 x 1-1/4 x .03 Washer	2		F026	10-24 x 1/2 PPHMS	4
12	6621	Linear Actuator (11-3/4)	1		F027	10-24 x 5/8 PPHMS	1
13	6630	Hitch Lift Crank	1		F036	1/4-20 x 1/2 SBH Screw	2
14	6621-1	Clevis Pin (1/2 x 2)	2		F068	1/8 x 1 Cotter Pin	4
15	6624	Mounting Frame Assembly, Hitch (Includes Item # 17-18)	1		F213	3/4-10 Jam Nut	1
16	6618	Decal, Hitch Mount Adjust	1	NOTE: Decals are illustrated in greater detail in the DECALS section on Page 5.			
17	6619	Mount Adjustment Bolt	1	* NS Non-Sellable			
18	8735-10	Rubber Mat (5 x 6)	2				
19	6626	Pivot Shaft	1				

Beginning S/N 10-4651
Effective Date 03.29.10
Use only genuine **Walker®** replacement parts

IMPLEMENT HITCH ASSEMBLY (H10)

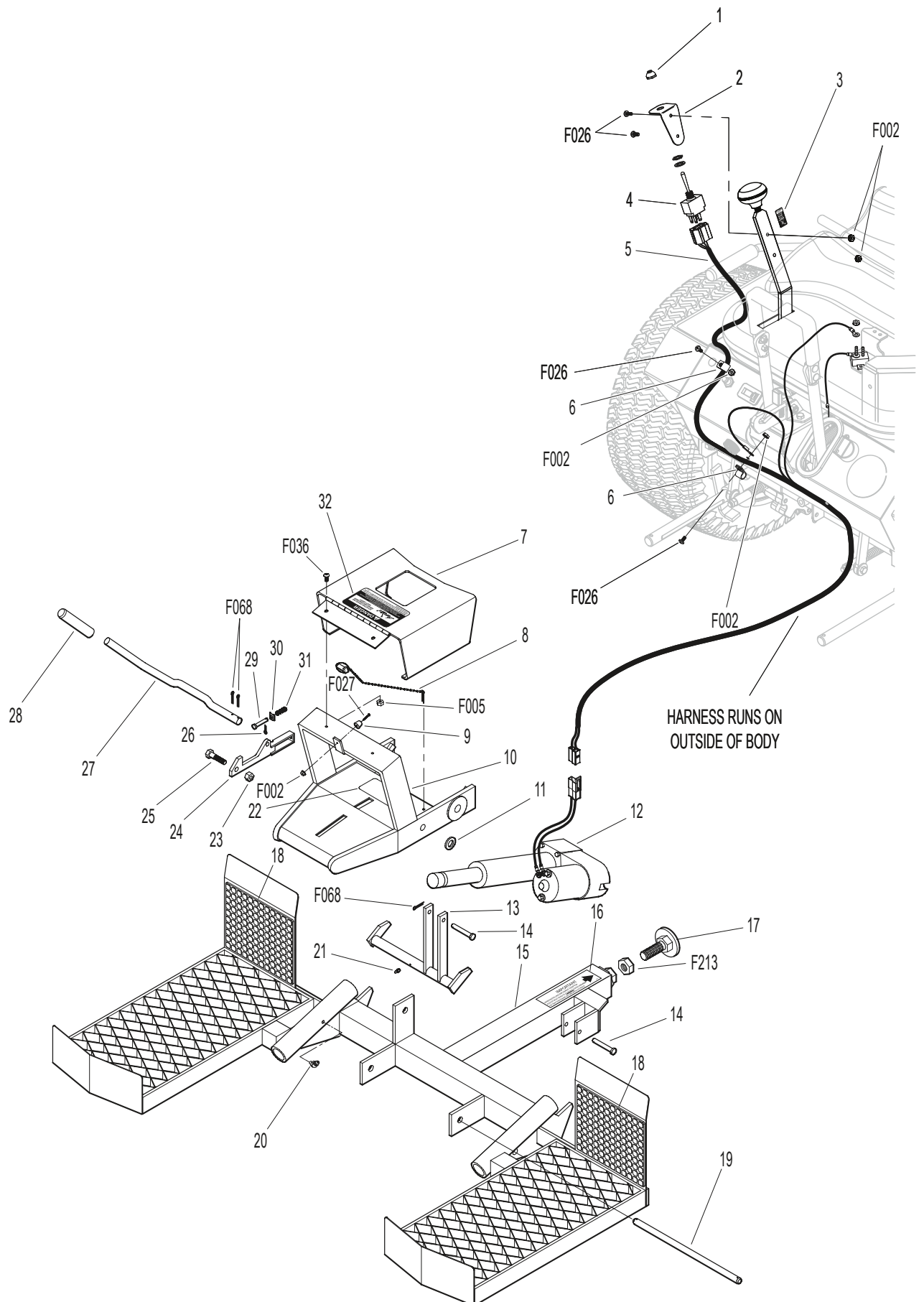

IMPLEMENT HITCH ASSEMBLY (H19)

ITEM NO.	PART NO.	DESCRIPTION	NO. REQ'D	ITEM NO.	PART NO.	DESCRIPTION	NO. REQ'D
Implement Mount Hitch				Fasteners			
1	6623-1	Switch Boot	1	F002	10-24 Keps Nut		3
2	6628	Switch Mount Bracket	1	F004	1/4-20 Keps Nut		4
3	6632	Decal, Implement Hitch / Lexan	1	F009	5/16-18 Whiz Locknut		6
4	6623	Toggle Switch	1	F013	3/8-16 Whiz Locknut		4
5	8553	Splice Tap (18-14 Ga.)	1	F014	3/8-16 ESNA Nut		2
6	6622	Wiring Harness	1	F026	10-24 x 1/2 PPHMS		3
7	5832	Cable Clamp (1/2)	1	F029	1/4-20 x 1/2 Hex Bolt		2
8	6619-4	Nerf Bar, RH	1	F034	5/16-18 x 3/4 Hex Bolt		6
9	7822	Decal, PTO Shield / Danger	1	F038	3/8-16 x 1 Hex Bolt		4
10	6621-12	Decal, Locking Mechanism	1	F049	5/16 SAE Washer		3
11	6619-15	PTO Shield (Includes Item # 9)	1	F068	1/8 x 1 Cotter Pin		2
12	6621-10	Chassis Support Strap	2	F069	3/32 x 1/2 Cotter Pin		2
13	5830	Grease Fitting	3	F111	1/8 x 3/4 Cotter Pin		3
14	6619-11	Main Frame Weldment (Includes Item # 13)	1	F134	AN960816L Washer		3
15	NS	Serial Number Plate	1	F209	.765 ID x 1.312 OD x .032 Washer		2
16	6619-3	Nerf Bar, LH	1	F246	1/4-20 x 1/2 PTHMS		2
17	5975-7	Cable Tie (50# x 11")	1				
18	4407-5	Bow Tie Cotter Pin	1				
19	6619-1	Rear Actuator Mount	1				
20	6621-1	Clevis Pin (1/2 x 2)	2				
21	6619-5	Pivot Shaft	1				
22	6621-9	Clevis Pin (1/2 x 2-1/2)	2				
23	6619-9	Pivot Shaft Weldment	1				
24	6619-13	Pivot Saddle, LH	1				
25	6619-18	Tongue Latch	1				
26	5281-2	Clevis Pin (5/16 x 7/8)	2				
27	9130-4	Clevis Pin (5/16 x 1)	2				
28	6619-12	Pivot Saddle, RH	1				
29	6619-19	Tongue Support Arm (Includes Item #13)	1				
30	4407-4	Bow Tie Cotter Pin	2				
31	6619-16	Clevis, Male	1				
32	6619-17	Clevis, Female	1				
33	5850-3	Handle Grip, Foam (3-1/4)	1				
34	6619-29	Locking Arm (Includes Item # 33)	1				
35	6621-11	Linear Actuator	1				

Beginning S/N 15-5951

Effective Date 10.01.15

Use only genuine **Walker®** replacement parts.

IMPLEMENT HITCH ASSEMBLY (H19)

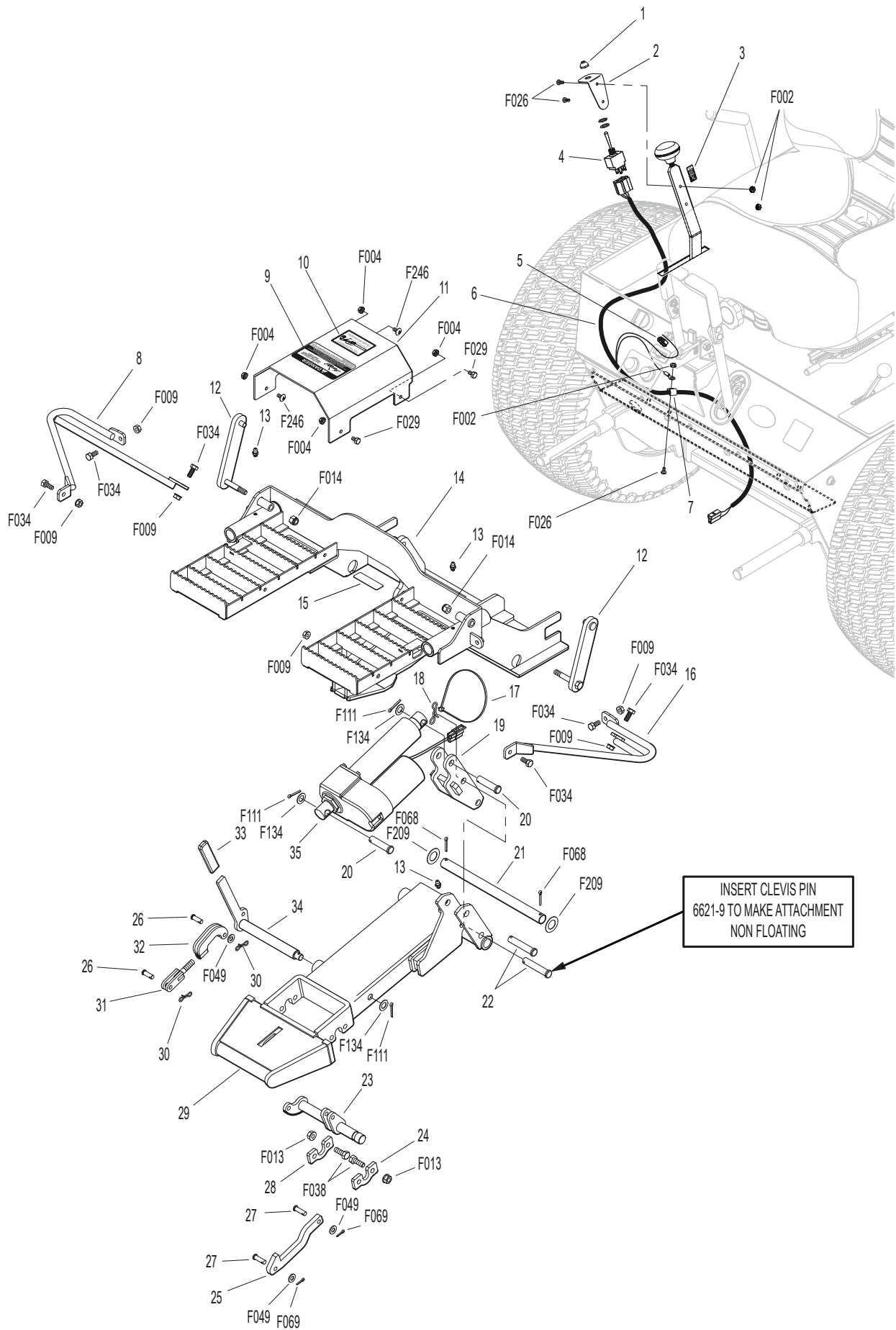

OPERATOR'S NOTES

LIMITED WARRANTY FOR WALKER IMPLEMENT HITCH

1. What this warranty covers, and for how long:

Walker Manufacturing company will, at its option, repair or replace, without charge, any part covered by this warranty which is found to be defective in material and/or workmanship within one (1) year* after date of sale to the original retail purchaser unless the product is used for rental purposes, in which case this warranty is limited to ninety (90) days. At Walker's request, customer will make the defective part available for inspection by Walker and/or return the defective part to Walker, transportation charges prepaid.

2. What this warranty does not cover:

A. This warranty does not cover defects caused by depreciation or damage caused by normal wear, accidents, improper maintenance, improper use or abuse of the product, alterations, or failure to follow the instructions contained in the Operator's Manual for operation and maintenance.

B. The customer shall pay any charges for making service calls and/or for transporting the attachment to and from the place where the inspection and/or warranty work is performed.

3. How to obtain service under this warranty:

Warranty service can be arranged by contacting the dealer where you purchased the machine or by contacting Walker Manufacturing Company, 5925 East Harmony Road, Ft. Collins, CO 80528. Proof of the date of purchase may be required to verify warranty coverage.

4. Warranty limitation:

A. THERE IS NO OTHER EXPRESS WARRANTY. ANY WARRANTY THAT MAY BE IMPLIED FROM THIS PURCHASE INCLUDING MERCHANTABILITY AND FITNESS FOR A PARTICULAR PURPOSE IS HEREBY LIMITED TO THE DURATION OF THIS WARRANTY AND TO THE EXTENT PERMITTED BY LAW ANY AND ALL IMPLIED WARRANTIES ARE EXCLUDED. Some states do not allow limitations on how long an implied warranty lasts, so the above limitations may not apply to you.

B. WALKER WILL NOT BE LIABLE FOR ANY INCIDENTAL, CONSEQUENTIAL, OR SPECIAL DAMAGES AND/OR EXPENSES IN CONNECTION WITH THE PURCHASE OR USE OF THE MACHINE. Some states do not allow the exclusion or limitation of incidental or consequential damages, so the above limitation(s) or exclusion(s) may not apply to you.

C. Only the warranty expressed in this limited warranty shall apply and no dealer, distributor, or individual is authorized to amend, modify, or extend this warranty in any way. Accordingly, additional statements such as dealer advertising or presentations, whether oral or written, do not constitute warranties by Walker, and should not be relied upon.

D. This warranty gives you specific legal rights, and you may also have other rights which vary from state to state.



WALKER

WALKER MFG. CO. 5925 HARMONY ROAD, FORT COLLINS, CO. 80528 - (970)221-5614
FORM NO. 111315 PRINTED IN USA