

## **WALKER MANUFACTURING COMPANY SC5661 OPERATOR CAB**

1. Install cab mount frame, P/N 7669-10, onto body assembly, P/N 6100, as shown on Figure 1:
  - (a) Locate front bar along front of seat with the front surface flush with the body fold line.
  - (b) Center back bar (measure approximately 7-3/16" from edge of body to outside end of angle).
  - (c) Mark and drill four (4) 5/16" mounting holes in body assembly and attach as shown on Figure 1.
2. Install front mount supports:
  - (a) Install RH side frame, P/N 7664-2, into its mounting hole in cab mount frame as shown on Figure 1.
  - (b) Place RH Mount Angle, P/N 5672, onto front mounting pin of cab mount frame as shown on Figure 1. Position the mount bracket along side of rectangular tubing of the cab frame. Mark and drill two (2) 1/4" mounting holes through rectangular tube in cab and attach as shown on Figure 1, View A-A.  
  
Follow same procedure for LH Mount Angle, P/N 5673, and LH side frame, P/N 7664-20.
3. Assemble cab frame; remove RH and LH side frames from the tractor and assemble cab frame as shown on Figure 2. Follow sequence below for assembly:
  - (a) Lay RH side frame flat on floor with pins facing "up."
  - (b) Install cross tubes, top support and front support on frame. Note rope hook on one side of front support and install down or towards RH side.
  - (c) Slide LH frame onto cross tubes; stand cab up.
  - (d) Mount windshield frame, complete with safety glass, to cab frame using four (4) F128 bolts and four (4) F002 Keps nuts (see Figure 2). NOTE: Do not install wiper motor at this time.
  - (e) Install cab frame onto tractor. Secure with four (4) hitch pins, P/N 7666.
4. Install cab fabric cover, P/N 7661. Place cab fabric over cab frame assembly and align as closely as possible. Fasten Velcro around windshield first. Next, route drawstring for RH side, according to Figure 1, and tension rope with spring, P/N 5222. Fasten Velcro on LH side and across back. It will be necessary to repeat above procedure several times in order to achieve proper fit. The fabric and Velcro will stretch, especially the first 48 hours after installation.
5. Install wiper motor and switch mount. See Figure 2. NOTE: It is highly recommended to wait 48 hours after initial installation of cover before proceeding with wiper motor installation. It is necessary to cut hole in fabric for motor shaft, and this should be done after fabric has stretched and final adjustments of fit have been done.

6. Connect wiring:

- (a) Connect 6" wire assembly, P/N 5670-2, from switch to motor.
- (b) Connect 9 ft. wire assembly, P/N 5670-1, to switch and route as shown in Figure 2. Secure to cab frame with wire ties, P/N 5975-1.
- (c) Drill 1/4" hole in tractor body adjacent to wire exit from cab frame and install grommet, P/N 5667.
- (d) Route 48" wire assembly, P/N 5670-3, through grommet, along underside of body, toward front of body, and secure with wire clips, P/N 5975-5. Connect wire to light wire plug. It will be necessary to cut wire to proper length and install appropriate end.

7. Install wiper arm. NOTE: Before installing wiper arm, P/N 5668, run wiper motor to determine proper arc of travel for wiper arm.

8. Install door fabric onto door frame, P/N 7662, using extension spring, P/N 5222. Route drawstring through loop on door brace and tie to spring as shown on Figure 1. Install door latch assembly, P/N 7667, as shown on Figure 2. NOTE: Door hinges and door latch assembly require occasional lubrication.

NOTE: For machines equipped with catcher lift handles, it is recommended that they are removed when installing the cab.

NOTE: When necessary to raise body for service, cab must be removed from mounting frame. Disconnect wiper motor wire at bullet connector before removal.

## PARTS LIST FOR FIGURE 1

ITEM NO.	PART NO.	DESCRIPTION	QTY. REQ'D
1	5672	RH Mount Angle	1
2	5673	LH Mount Angle	1
3	5222	Extension Spring	2
4	7661	Cab Fabric, Sewn	1
5	7662	Door, Cab	1
6	7669-10	Cab Mount	1
7	5670-3	Wire Assembly, 36"	1
8	7666	Hitch Pin #3	4
F004	F004	1/4-20 Keps Nut	4
F009	F009	5/16-18 Whiz Locknut	4
F033	F033	1/4-20 X 1" PTH Bolt	4
F091	F091	5/16-18 X 5/8" Hex Bolt	4

## PARTS LIST FOR FIGURE 2

ITEM NO.	PART NO.	DESCRIPTION	QTY. REQ'D
9	7664-2	Cab Frame, RH	1
10	5670-1	Wire Assembly, 9 Ft., Cab	1
11	7669-1	Front Support, Cab	1
12	7669-2	Top Support, Cab	1
13	7669-3	Cross Tube, Cab	2
14	5519	Actuator Motor (Incl. 19 & 20)	1
15	5995	Toggle Switch, Off-On	2
16	5667-1	Switch Mount Bracket, Cab	1
17	5995-2	Switch Boot	*
18	7664-20	Cab Frame, LH	1
19	5519-3	Motor Mount Nut (5/8-24 Panel Nut)	*
20	5519-2	Motor Mount Washer	*
21	5668	Arm, Wiper	1
22	5669	Blade, Wiper	1
23	5674	Windshield and Frame (Incl. 24, 25, 26)	1
24	7665	Glass Windshield	*
25	7663	Windshield Frame	*
26	7665-1	Glass Windshield Seal	*
27	7662	Door, Cab	1
28	5670-3	Wire Assembly, 36"	1
29	5989-2	Light Assembly	2
30	5996-15	Ring Wire Terminal, 1/2"	*
31	5996-4	14 GA Bullet Connector, Male	*
32	5996-5	14 GA Bullet Connector, Female	*
33	7667	Door Handle	1
34	5989-6	Sealed Beam Lamp	*
F002	F002	10-24 Keps Nut	7
F026	F026	10-24 X 1/2" PPHMS	2
F128	F128	10-24 X 3/8" PTH Bolt	4
F129	F129	10-24 X 1/2" PTH Bolt	1
F134	F134	AN960816L Washer	*
F282	F282	3/8-16 X 1" Carriage Bolt	*

\* Service Part Only

### THE FOLLOWING PARTS ARE NOT ILLUSTRATED:

5975-1	Cable Tie (18# X 3-3/4")	10
5670-2	Wire Assembly 6"	1
5667	Grommet, 1/8" ID X 1/4" OD	1
5975-5	Wire Clip	3
5996	Wire Terminal, Female	1

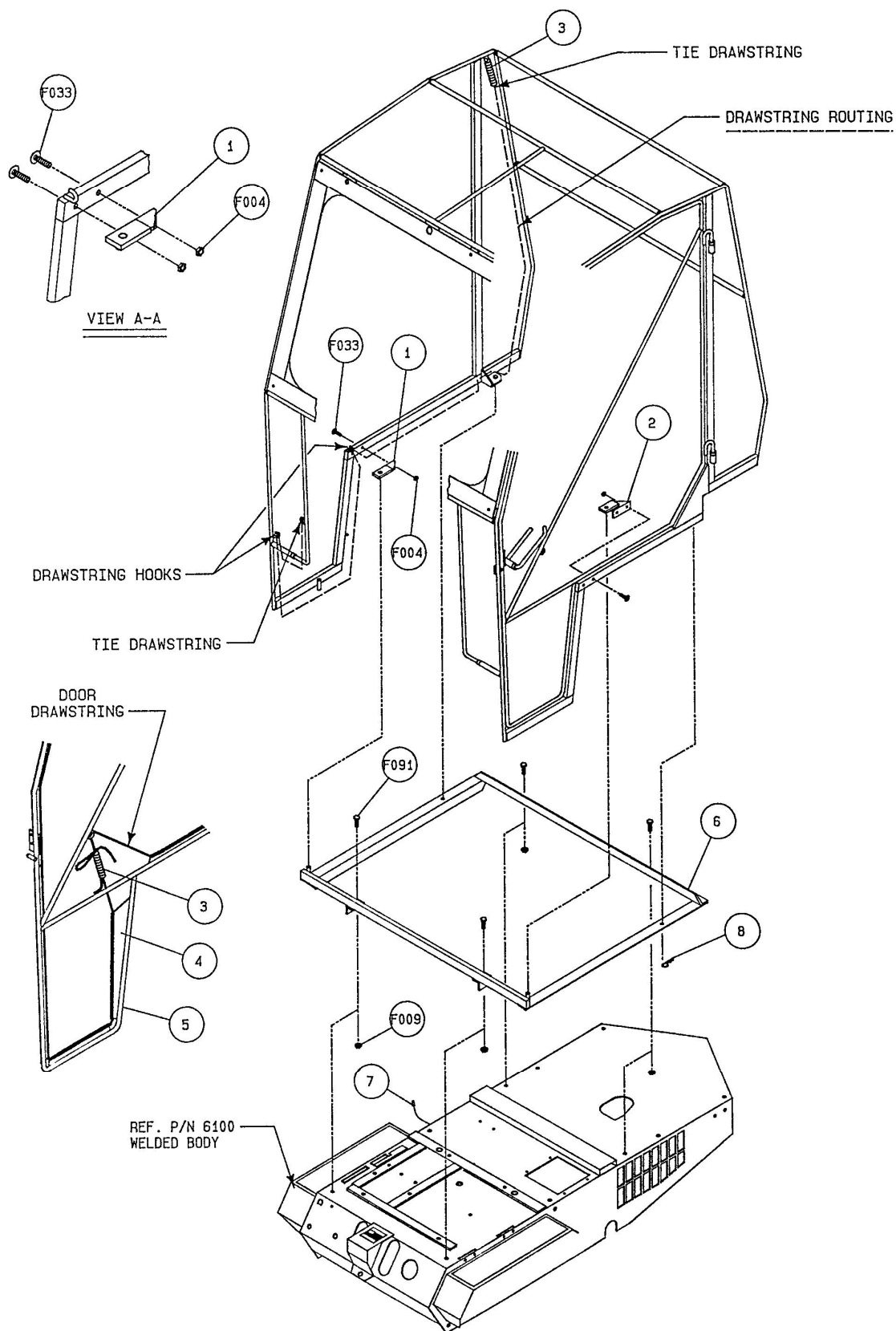

FIGURE 1 - P/N SC5661 OPERATOR CAB ASSEMBLY

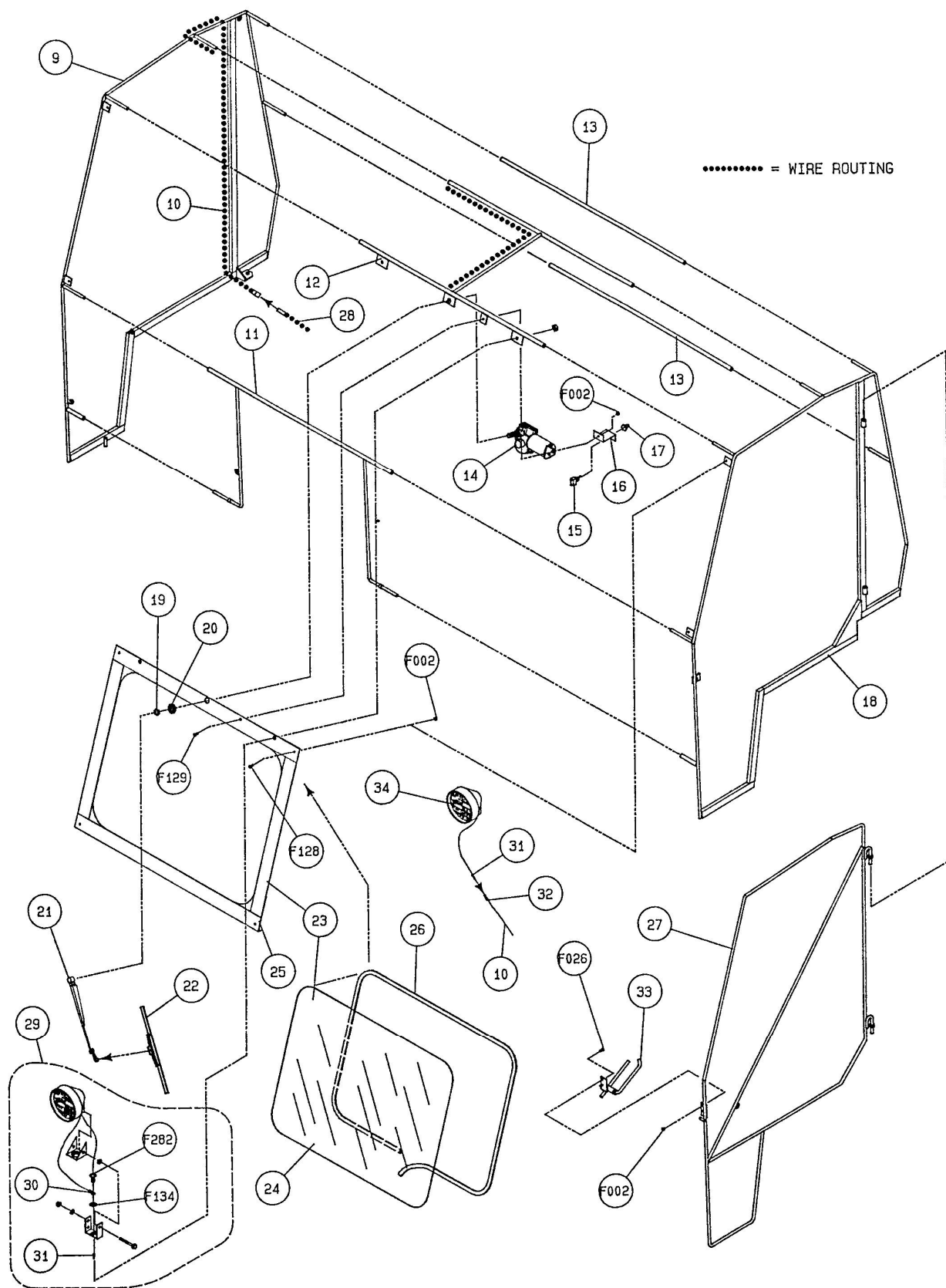

FIGURE 2 - P/N SC5661 OPERATOR CAB ASSEMBLY